

All dimensions to be checked on site
This drawing is copyright
Do not scale

Elevation A

Do not reproduce without permission

NB ALL WINDOWS TO BE IN WHITE UPVC WITH DOUBLE GLAZED UNITS TO ACHIEVE A U-VALUE OF 2.0 W/m²K

ALL DOORS AND THEIR ASSOCIATED FRAMES AND FANLIGHTS TO BE IN POLYESTER POWDER COATED ALUMINIUM WITH DOUBLE GLAZED UNITS TO ACHIEVE A U-VALUE OF 2.2 W/m²K

new galvanised steel fire escape / access stairs to dining room—
280mm min going
150mm max rise
1200mm wide (clear)
balustrading to be 900mm high on flights, 100mm high on landings and non-climbable
balustrading and risers to be constructed so that a 100mm dia sphere can not pass through any gaps

existing window opening infilled

insulated panel to lower panes of ED1



Elevation B

insulated panel to lower pane of ED4

new galvanised steel fire escape / access stairs to dining room—
280mm min going
150mm max rise
1200mm wide (clear)
balustrading to be 900mm high on flights, 100mm high on landings and non-climbable
balustrading and risers to be constructed so that a 100mm dia sphere can not pass through any gaps

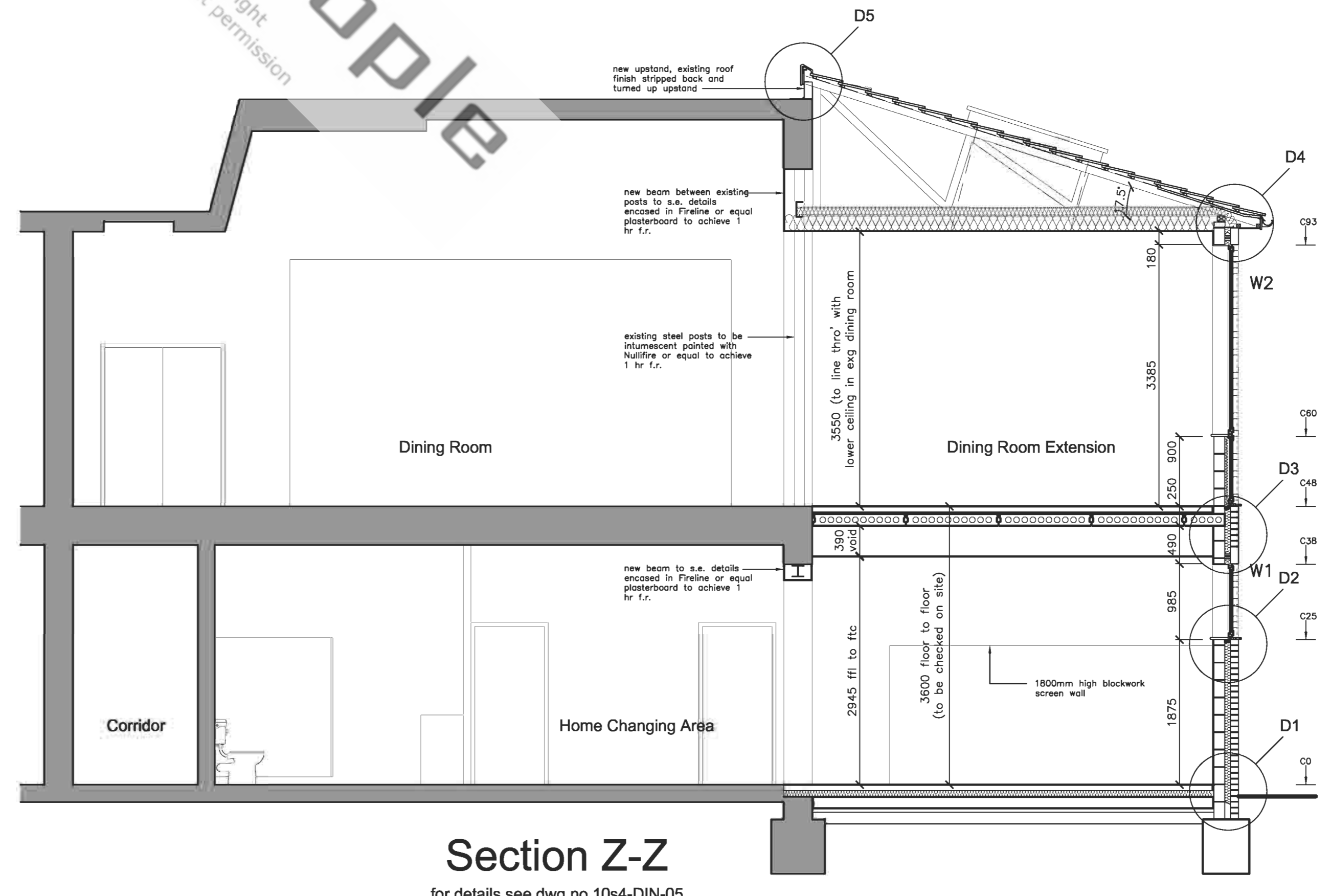

Section Z-Z

for details see dwg no 10s4-DIN-05

REV A: Additional stairs notes added. Dec 04

plans people DESIGN STUDIO PO Box 13241 Studley Warwickshire B97 9DL T 01527 45 25 93 F 01527 45 25 93 E plans.people@blueyonder.co.uk	
client	Extension to Dining and Changing Rooms-
title	Proposed Elevations & Section Z-Z Working Drawing
scale: 1:50 @ A1	date: Nov 04
drawing no DIN-03	amendment A